

(4) Ø.67 MOUNTING HOLE ON Ø16.1 BC

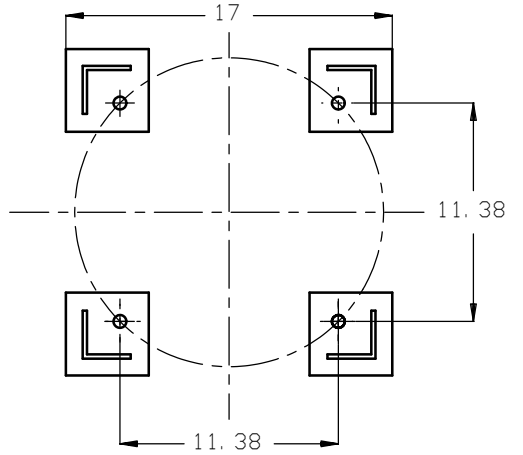

DIMENSIONS		
MODEL NO.	A (in)	B (in)
GTCH213-	61.9	54.5
GTCH214-	71.9	64.5

SHIPPING WEIGHT AND SIZE MAY DIFFER FROM STATED VALUES DUE TO PALLETIZING AND QUANTITY CONSIDERATIONS

VESSEL SIZE	BOXED WEIGHT (LBS)	BOX SIZE (INCHES)
GTCH213-		
GTCH214-	550	45 x 48 x 92

**PROPRIETARY AND CONFIDENTIAL**  
THE INFORMATION CONTAINED IN THIS DRAWING IS THE SOLE PROPERTY OF GLOBAL FILTER LLC. ANY REPRODUCTION IN PART OR AS A WHOLE WITHOUT THE WRITTEN PERMISSION OF GLOBAL FILTER LLC IS PROHIBITED.

- NOTES:
- UNLESS TOLERANCES ARE INDICATED, ALL DIMENSIONS ARE REFERENCE.
  - ALL MODELS COMPLY WITH REQUIREMENTS FOR DESIGN AND CONSTRUCTION IN ACCORDANCE WITH THE ASME BOILER & PRESSURE VESSEL CODE, SECTION VIII, DIVISION 1. MODELS BEARING THE "U" OR "UM" STAMP ARE REGISTERED WITH THE NATIONAL BOARD OF BOILER AND PRESSURE VESSEL INSPECTORS.

TABULATION

PART NO.	DESCRIPTION	GLOBAL FILTER MODEL NO.
CS098-01	FLTR HSG ASSY, GTCH21 SER, 20", 4F, 304 SS, GB, CODE	GTCH2124F2415GBU
CS098-02	FLTR HSG ASSY, GTCH21 SER, 20", 4F, 304 SS, GB	GTCH2124F2415GB
CS098-03	FLTR HSG ASSY, GTCH21 SER, 30", 4F, 304 SS, GB, CODE	GTCH2134F2415GBU
CS098-04	FLTR HSG ASSY, GTCH21 SER, 30", 4F, 304 SS, GB	GTCH2134F2415GB
CS098-05	FLTR HSG ASSY, GTCH21 SER, 40", 4F, 304 SS, GB, CODE	GTCH2144F2415GBU
CS098-06	FLTR HSG ASSY, GTCH21 SER, 40", 4F, 304 SS, GB	GTCH2144F2415GB
CS098-07	FLTR HSG ASSY, GTCH21 SER, 20", 4F, 316 SS, GB, CODE	GTCH2124F2615GBU
CS098-08	FLTR HSG ASSY, GTCH21 SER, 20", 4F, 316 SS, GB	GTCH2124F2615GB
CS098-09	FLTR HSG ASSY, GTCH21 SER, 30", 4F, 316 SS, GB, CODE	GTCH2134F2615GBU
CS098-10	FLTR HSG ASSY, GTCH21 SER, 30", 4F, 316 SS, GB	GTCH2134F2615GB
CS098-11	FLTR HSG ASSY, GTCH21 SER, 40", 4F, 316 SS, GB, CODE	GTCH2144F2615GBU
CS098-12	FLTR HSG ASSY, GTCH21 SER, 40", 4F, 316 SS, GB	GTCH2144F2615GB
CS098-13	FLTR HSG ASSY, GTCH21 SER, 20", 4F, 304 SS, EP, CODE	GTCH2124F2415EPU
CS098-14	FLTR HSG ASSY, GTCH21 SER, 20", 4F, 304 SS, EP	GTCH2124F2415EP
CS098-15	FLTR HSG ASSY, GTCH21 SER, 30", 4F, 304 SS, EP, CODE	GTCH2134F2415EPU
CS098-16	FLTR HSG ASSY, GTCH21 SER, 30", 4F, 304 SS, EP	GTCH2134F2415EP
CS098-17	FLTR HSG ASSY, GTCH21 SER, 40", 4F, 304 SS, EP, CODE	GTCH2144F2415EPU
CS098-18	FLTR HSG ASSY, GTCH21 SER, 40", 4F, 304 SS, EP	GTCH2144F2415EP
CS098-19	FLTR HSG ASSY, GTCH21 SER, 20", 4F, 316 SS, EP, CODE	GTCH2124F2615EPU
CS098-20	FLTR HSG ASSY, GTCH21 SER, 20", 4F, 316 SS, EP	GTCH2124F2615EP
CS098-21	FLTR HSG ASSY, GTCH21 SER, 30", 4F, 316 SS, EP, CODE	GTCH2134F2615EPU
CS098-22	FLTR HSG ASSY, GTCH21 SER, 30", 4F, 316 SS, EP	GTCH2134F2615EP
CS098-23	FLTR HSG ASSY, GTCH21 SER, 40", 4F, 316 SS, EP, CODE	GTCH2144F2615EPU
CS098-24	FLTR HSG ASSY, GTCH21 SER, 40", 4F, 316 SS, EP	GTCH2144F2615EP

BILL OR MATERIALS		
ITEM	DESCRIPTION	QTY
1	EYE BOLT KIT, 5/8"-11 x 4.75	10
2	TIE ROD NUT	7
3	TIE ROD, THREADED BOTH ENDS	7
4	SPRING HOLD DOWN	21
5	HOLD DOWN PLATE	7
6	O-RING, 469 x 7	1
7	V-POST	21
8	HAND WHEEL, 9"	1

REFERENCE ENGINEERING DRAWING 21133

A		EC150219-02		MATERIAL SEE TABULATION TABLE		FINISH SEE TABULATION TABLE		TITLE: <b>GLOBAL FILTER LLC</b> FLTR HSG ASSY, 4" FLG SISO GTCH21 SER, TAB	
REV	EC NUMBER	NAME	DATE						
EC HISTORY		ENG APPR.	EG	2-27-15	3-2-15	SIZE <b>B</b>	DWG. NO. <b>CS098</b>	REV <b>A</b>	
				SCALE: 1:10		WEIGHT:		SHEET 1 OF 1	