

- Industrial liquid housing for prefiltration and clarification duties
- STANDARD product
 - BSP (G) or NPT connections and standard finish
- PLUS product
 - Available in 3 different vessel classes: Standard (CE), ATEX and High Pressure
 - Standard and electropolished surface finishes available
 - A number of inlet / outlet port connections
 - Choice of BSP (G) / ISO 228, NPT or no vent
 - Choice of BSP (G) / ISO 228 or NPT drain
 - Option of C (226) location and fabricated (not cast) head



Specification

STANDARD Range

Materials of Construction

- Housing: Cast Head - Stainless Steel
Bowl - 316L Stainless Steel
- Seals: EPDM FDA
- Clamps: 304 Stainless Steel

Surface Finish

- Internal: As Welded
- External: Polished 0.8 µm Ra (32 µIn Ra)
All finishes pickled & passivated.

PLUS Range

Materials of Construction

- Housing: Cast Head - 316L Stainless Steel
Bowl - 316L - Stainless Steel
- Seals: EPDM FDA
PTFE FDA
Silicone FDA
Viton™ / FKM FDA
- Clamps: 304 Stainless Steel

Surface Finish

Two Finishes Available

- Standard Finish
Head-Cast, Pickled and Passivated
Bowl Internal: As Welded
Pickled and Passivated
Bowl External: Polished 0.8 µm Ra (32 µIn Ra)
- Standard Electropolished Finish
Head-Cast, Electropolished
Bowl Internal: Electropolished
Bowl External: Polished 0.8 µm Ra (32 µIn Ra)
All finished pickled and passivated

Welding

All assembly welds are full penetration.
All welds are crevice and undercut free.
Weld finish and detail drawings available upon request.

Certification

Supplied as standard with vessel inspection certificate.

Material Test Certification

EN10204 3.1 supplied upon request.

Directives

Housings designed in accordance with the European Council Pressure Equipment Directive (PED).
ATEX (where applicable).

Design Basis

ASME VIII Division 1.

Approvals

EAC 010-2011, (No. TC N RU D-GB. AM01.B.00512)
Approval type: Import Certificate, TR CU
Pressure Equipment (available on request),



STANDARD Range

Working Condition PED			Maximum Pressure		
Fluid Group	State	Temperature	011	012	013
Non Dangerous	Liquid / Gas	150 °C (302 °F)	10 barg (145 psig)	10 barg (145 psig)	10 barg (145 psig)
Dangerous	Liquid / Gas	150 °C (302 °F)	5 barg (73 psig)	5 barg (73 psig)	5 barg (73 psig)
PED Conformity Assessment Category			SEP	CAT I	CAT I
Volume (litres)			3.2	5.1	7.0

PLUS Range

Working Condition PED			Maximum Pressure				
Fluid Group	State	Temperature	011	012	013	014	
Non Dangerous	Gas / Vapour	150 °C (302 °F)	10 barg (145 psig)	10 barg (145 psig)	10 barg (145 psig)	10 barg (145 psig)	
Dangerous	Gas / Vapour	150 °C (302 °F)	5 barg (73 psig)	5 barg (73 psig)	5 barg (73 psig)	5 barg (73 psig)	
Non Dangerous	Liquid	150 °C (302 °F)	10 barg (145 psig)	10 barg (145 psig)	10 barg (145 psig)	10 barg (145 psig)	
Dangerous	Liquid	150 °C (302 °F)	5 barg (73 psig)	5 barg (73 psig)	5 barg (73 psig)	5 barg (73 psig)	
PED Conformity Assessment Category			Code B & D Code C	SEP SEP	CAT I SEP	CAT I CAT I	CAT I CAT I
Volume (litres)			Code B & D Code C	3.2 2.9	5.1 4.8	7.0 6.7	8.9 8.6

Working Condition PED			Maximum Pressure				
Fluid Group	State	Temperature	011	012	013	014	
Non Dangerous	Gas / Vapour	135 °C (275 °F)	10 barg (145 psig)	10 barg (145 psig)	10 barg (145 psig)	10 barg (145 psig)	
Dangerous	Gas / Vapour	135 °C (275 °F)	5 barg (73 psig)	5 barg (73 psig)	5 barg (73 psig)	5 barg (73 psig)	
Non Dangerous	Liquid	135 °C (275 °F)	10 barg (145 psig)	10 barg (145 psig)	10 barg (145 psig)	10 barg (145 psig)	
Dangerous	Liquid	135 °C (275 °F)	5 barg (73 psig)	5 barg (73 psig)	5 barg (73 psig)	5 barg (73 psig)	
PED Conformity Assessment Category			Code B & D Code C	SEP SEP	CAT I SEP	CAT I CAT I	CAT I CAT I
Volume (litres)			Code B & D Code C	3.2 2.9	5.1 4.8	7.0 6.7	8.9 8.6

Working Condition PED			Maximum Pressure				
Fluid Group	State	Temperature	011	012	013	014	
Non Dangerous	Gas / Vapour / Liquid	205 °C (401 °F)	16 barg (232 psig)	16 barg (232 psig)	16 barg (232 psig)	16 barg (232 psig)	
PED Conformity Assessment Category			Code B & D Code C	CAT I 2.9	CAT I 4.8	CAT I 6.7	CAT I 8.6
Volume (litres)			Code B & D Code C	3.2 SEP	5.1 CAT I	7.0 CAT I	8.9 CAT I

Note: All housings are full vacuum rated.

Physical Characteristics

Bowl Height	Dimensions (mm)			Typical Weight		
	'A'	'B'	'C'	Bowl	Head	Total
250 mm (10")	150 mm [5.9"]	441 mm [17.4"]	297 mm [11.7"]	1.5 Kg [3.3 lbs]	1.2 Kg [2.6 lbs]	3.8 Kg [8.4 lbs]
500 mm (20")	150 mm [5.9"]	691 mm [27.2"]	550 mm [21.7"]	2.5 Kg [5.5 lbs]	1.2 Kg [2.6 lbs]	4.9 Kg [10.8 lbs]
750 mm (30")	150 mm [5.9"]	936 mm [26.9"]	814 mm [32.0"]	3.5 Kg [7.7 lbs]	1.2 Kg [2.6 lbs]	6.0 Kg [13.2 lbs]

Dimensions shown are based on the STANDARD range. For accurate dimensions, please contact Parker donnick hunter.

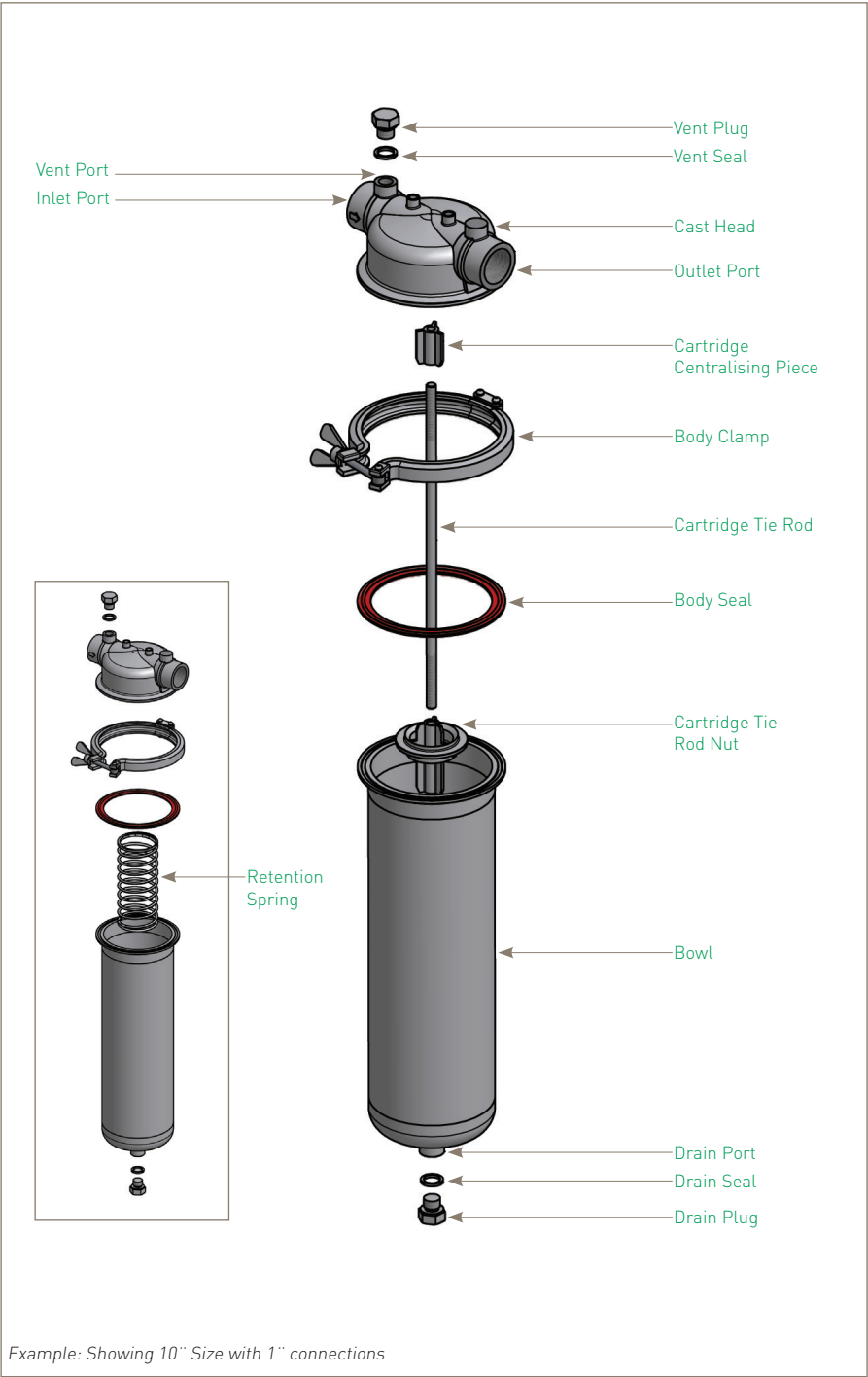
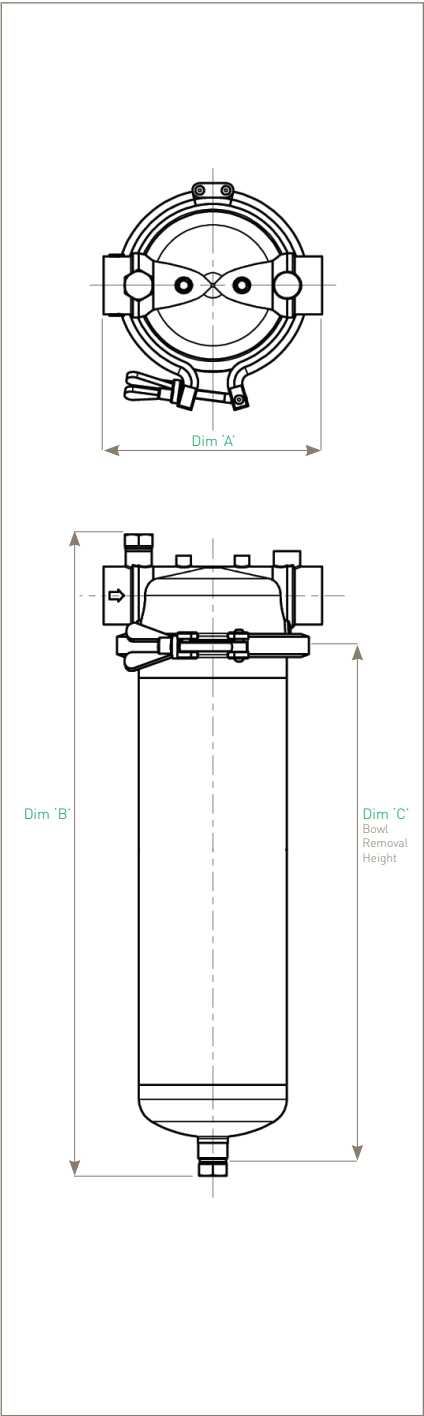

Example: Showing 10" Size with 1" connections

The PLUS product range is available with many options of connections, vents, drains, surface finish, seals classification, etc. Please see product coding.

STANDARD Range - 10" to 30"

HIL 01 - -

Code Vessel Class	Code Length (Nominal)	Code Connection Size	Code Standard	Code Cartridge	Code Seal
CE Standard	1 10" (250 mm) 2 20" (500 mm) 3 30" (750 mm)	B 1" (25.4 mm)	B BSPP (G) / ISO 228 N NPT	B DOE D 222	E EPDM

PLUS Range - 10" to 40"

HIL 01 - - -

Code Vessel Class	Code Length (Nominal)	Code Connection Size	Code Standard	Code Cartridge	Code Seal	Code Vent	Code Drain
CE Standard AT ATEX HP* High Pressure	1 10" (250 mm) 2 20" (500 mm) 3 30" (750 mm) 4 40" (1000 mm)	B 1" (25.4 mm) Y 1 1/2" (38.1 mm)	B ⁽¹⁾ BSPP (G) / ISO 228 F ⁽²⁾ FLANGE ANSI cl.150 H FLANGE ANSI cl.300 L EN 1092-1 PN16 N ⁽³⁾ NPT (F) T ⁽³⁾ Tri-Clamp®	B DOE C 226 (Fabricated Head) D 222	E EPDM P* PTFE S Silicone V Viton™ / FKM	B 1/4" BSPP (G) / 1/4" N 1/4" NPT X ⁽³⁾ No Vent	B 1/4" BSPP (G) / 1/4" N 1/4" NPT
* Supplied complete with a double bolted clamp				* Double bolted clamp required		³ Only available with 'C' Style cartridge configuration	
		¹ Only available in 1" connection ² Not suited for High Pressure vessels. HP Vessels to use ANSI RF 300. ³ Only available with 'C' Style cartridge configuration					
				Code Surface Finish			
				Internal External			
				E Standard Electropolished	Electropolished	0.8 µm	
				I Standard	As Welded	0.8 µm	
						Code Tagged	
						T Yes	
						X No	

For Tagged Options customer identification numbers required at time of ordering

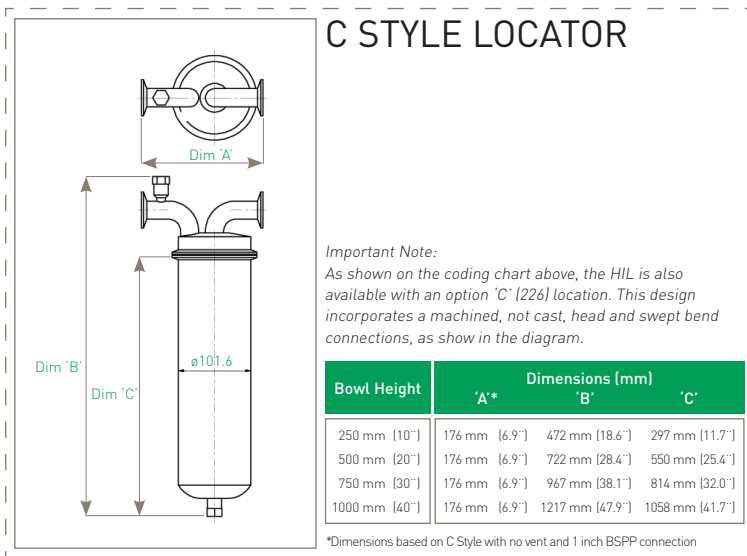

Tri-Clamp® is a trademark of Alfa-Laval, Inc.

Viton™ is a registered trademark of DuPont Performance Elastomers L.L.C..

Note: All Tri-Clamp® connections conform to BS4825 Pt. 3

Parker domnick hunter has a continuous policy of product development and although the Company reserves the right to change specifications, it attempts to keep customers informed of any alterations. This publication is for general information only and customers are requested to contact our Process Filtration Sales Department for detailed information and advice on a products suitability for specific applications. All products are sold subject to the company's Standard conditions of sale.



FISCHER-ROBERTSON, INC.
FILTRATION & SEPARATION

(513) 860-3445 | Sales@fischer-robertson.com